









# PLAN DE RESERVATION

## LEGENDE

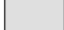
- |   |                    |   |  |
|---|--------------------|---|--|
|  ETEL                      | Tableau électrique |  Terrasse ou loggia en dalles sur plots    | PF : Porte-Fenêtre ouvrant à la française              |
|  Gaine                     | technique          |  Balcon sur platelage bois                 | FAFV : Fenêtre sur Allège Fixe Vitrée Oscillo Battant  |
|  Implantation PC interdite |                    |  Grille caillebotis                        | F : Fenêtre Oscillo Battant                            |
|  Soffite ou Faux-plafond   |                    |  Accessibilité Personne à Mobilité Réduite | VRE : Volet Roulant Electrique                         |
|   |                    |  Carrelage                                 | Pl. BEC : Placard Ballon d'Eau Chaude thermo-dynamique |
|   |                    |   | Pl. : Placard  |
|   |                    |   | 2m50 Hauteur sous plafond en partie courante           |

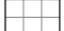
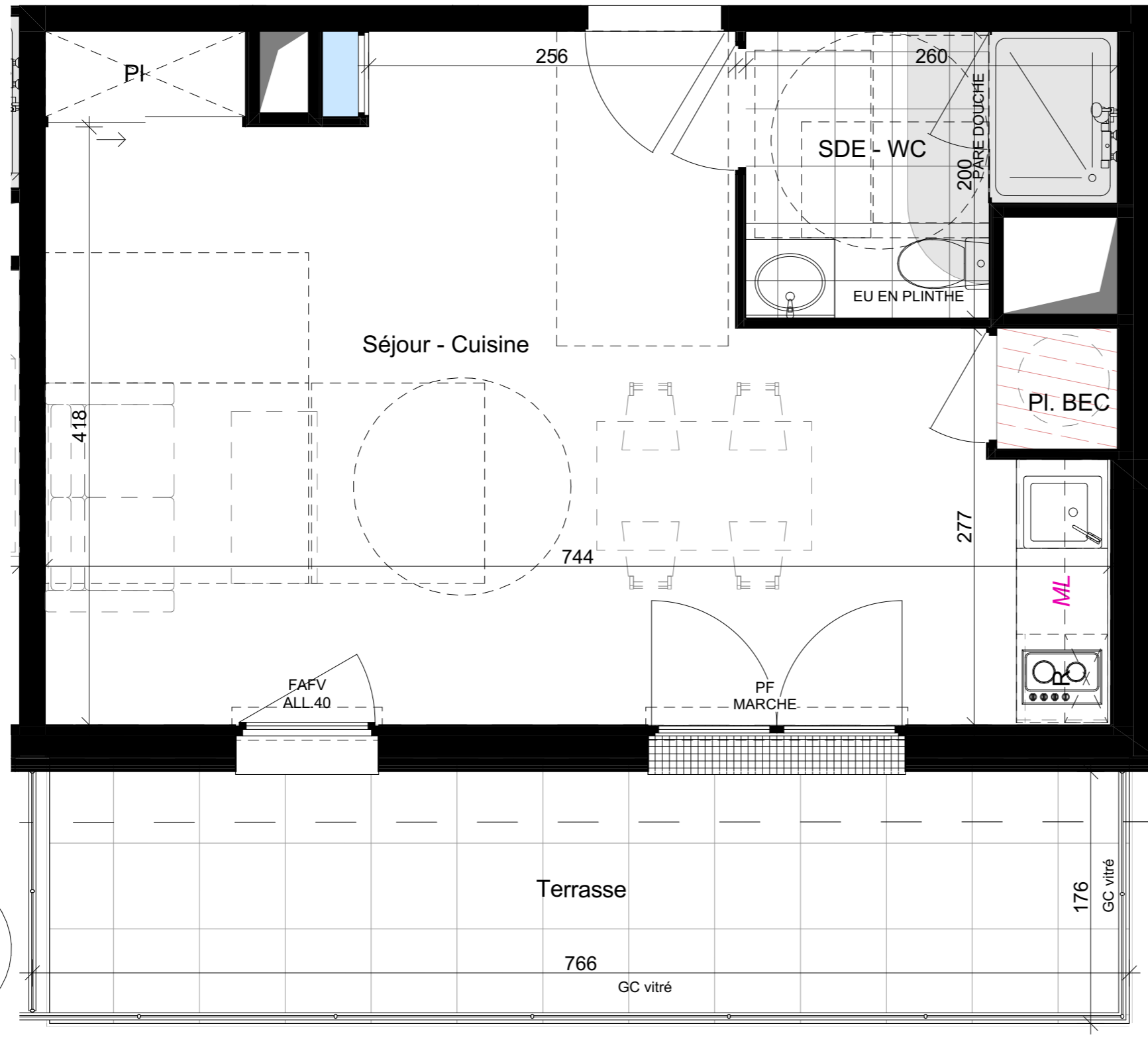

SASU AP67

Boulevard Ronsard, 44150 Ancenis-Saint-Géréon



## PADW

SCOP D'ARCHITECTURE

BATIMENT	NIVEAU	TYPE	N°LOG
<b>B</b>	<b>3</b>	<b>T1bis</b>	<b>B301</b>

### SURFACES HABITABLES

Séjour - Cuisine	28,3
SDE - WC	4,5
PI	0,9
Pl. BEC	0,7
<b>Total surfaces habitables</b>	<b>34,4 m<sup>2</sup></b>

### SURFACES ANNEXES

Terrasse	13,3
<b>Total surfaces annexes</b>	<b>13,3 m<sup>2</sup></b>

### PLAN DE REPERAGE

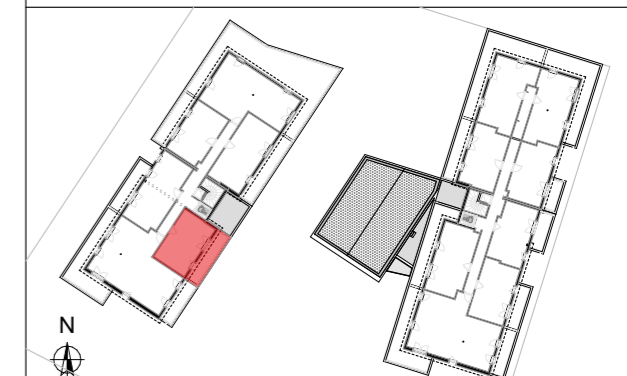

DATE CREATION 30/04/2025

DATE MISE A JOUR 19/03/2026

ECHELLE 1:35